

TAD1630V, TWD1630V

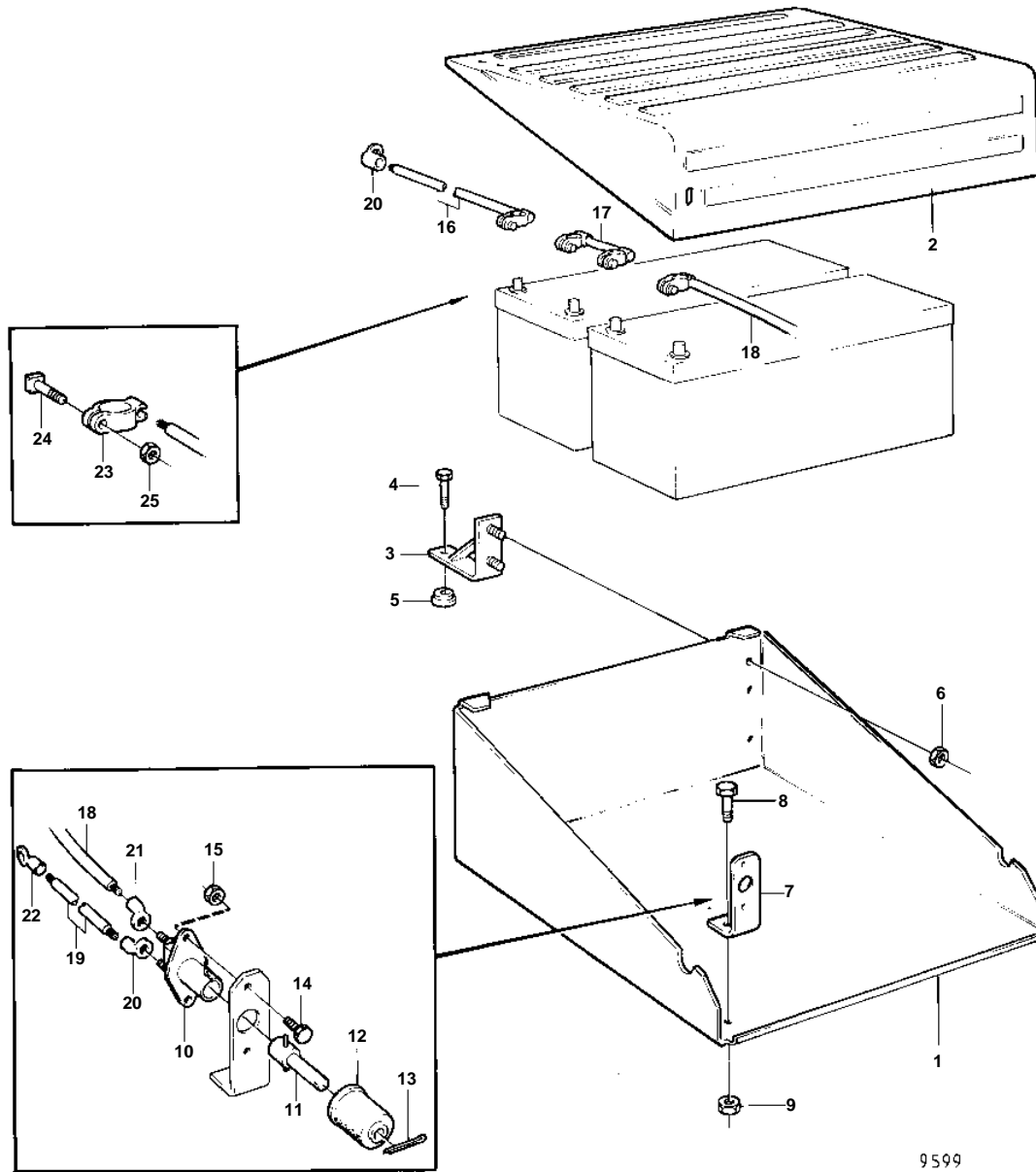

9599

TAD1630V, TWD1630V

| REF | PART NO. | QTY | DESCRIPTION         | NOTES           |
|-----|----------|-----|---------------------|-----------------|
| 1   | 863627   | 1   | Battery box         |                 |
| 2   | 1587694  | 1   | Cover               |                 |
| 3   |          | 2   | Bracket             |                 |
| 4   | 946472   | 2   | Screw               |                 |
| 5   | 846284   | 2   | Washer              |                 |
| 6   | 971096   | 4   | Nut                 |                 |
| 7   | 1587695  | 1   | Bracket             |                 |
| 8   | 946441   | 2   | Screw               |                 |
| 9   | 971095   | 2   | Nut                 |                 |
| 10  | 3987034  | 1   | Battery main switch | (8151943)       |
| 11  | 1587017  | 1   | Key                 |                 |
| 12  | 1582293  | 1   | Bellows             |                 |
| 13  | 1581000  | 1   | Pin                 |                 |
| 14  | 946544   | 2   | Flange screw        |                 |
| 15  | 945407   | 2   | Flange nut          |                 |
| 16  |          | X   | Battery cable       | 70mm2x1650mm    |
| 17  |          | X   | Battery cable       | 70sq.mm x 125mm |
| 18  |          | X   | Battery cable       | 70mm2x250mm     |
| 19  |          | X   | Battery cable       | 70mm2x2100mm    |
| 20  |          | X   | Cable terminal      |                 |
| 21  |          | X   | Cable terminal      |                 |
| 22  |          | X   | Cable terminal      |                 |
| 23  | 954506   | X   | Cable terminal      | +               |
|     | 954505   | X   | Cable terminal      | -               |
| 24  |          | X   | Screw               |                 |
| 25  |          | X   | Nut                 |                 |